



TyBOT[®]

3.0 PRICING SHEET



TYBOT 3.0

BASE MODEL (11'-28') **\$391,500**

Driver Gantry & Passenger Gantry with Stops
Tram with two (2) Cameras & Camera Sunglass Set
Three (3) @ Gen4 Tie Modules
PREDATOR 8750 Inverter Generator with standard OMW
SCANRECO Belly Box & Spare Battery with standard OMW
Assembly Leg Set & Ladder Hooks Set
40' Truss Jumper Harness
Two (2) Year Warranty on OEM Parts (excludes Wear Parts & Tie Modules)
Three (3) onsite ACR Supervisor days for unloading, commissioning & training (one trip)
Four (4) days training at ACR on advanced operations, maintenance, & configurations

STANDARD MODEL (11'-64') **\$425,500**

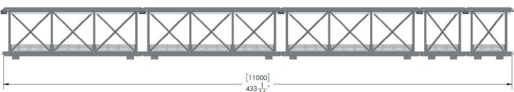

TyBOT Base Model
Two (2) @ 1M Sections
Three (3) @ 3M Sections

EXTENDED MODEL (11'-117') **\$455,500**

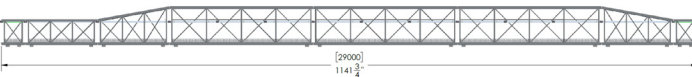

TyBOT Base Model
Two (2) @ 1M Sections
One (1) @ 3M Sections
Two (2) @ 3M Transitions (Driver & Passenger)
Three (3) @ 6M Sections

EXTENDED TYBOT TWO-YEAR WARRANTY **\$25,000 / BOT**
OEM Parts (excludes Wear Parts & Tie Modules)

CANADIAN COMPLIANCE **\$10,000 / BOT**
CSA Group SPE-1000 Certification

TYBOT ACCESSORIES

TRUSS OPTIONS

1M MIDDLE	\$4,250
3M MIDDLE	\$9,500
3M TRANSITION (DRIVER)	\$10,000
3M TRANSITION (PASSENGER)	\$10,000
6M MIDDLE	\$11,750

TRAVEL MODE OPTIONS

EDGE FORM BOGIE SET (FOUR (4) BOGIES)	\$65,000
PORTA-RAIL STAND SET (SIXTY (60) STANDS)	\$15,000

ADDITIONAL OPTIONS

OPERATIONAL START-UP KIT	\$1,500
Four (4) @ 20', 2 @ 12' & two (2) @ 4' Eye to Eye Web Slings	
One (1) @ 50' Tag Line	
Two (2) @ 5 GAL Refueling Cans	
One (1) @ 8' Ladder & one (1) @ 3' Stepstool	

TYBOT BOX	\$2,500
60" Job Box for shipping & onsite storage	
Custom Tie Module cradle & camera storage	
Holds rigging, six (6) Tie Wire spools & tools	

1M CUSTOM LOGO PANEL SET	\$2,500
--------------------------	---------

MATERIAL TRANSPORT OPTIONS

MAIN CARRY HOIST	\$60,000
1-Ton Hoist, Power Source, Weight Dashboard, Hoist Pendant Control, Storage, & Flood Light	
SUPPORT CARRY HOIST	\$35,000
1-Ton Hoist, Storage, & Flood Light. Requires Main Carry Hoist	

Disclaimer: All prices are shown in US Dollars. Prices do not include applicable sales tax, freight, or shipping unless otherwise noted.
Prices effective 9/1/24 and subject to change.



ONGOING ACR SOFTWARE & SUPPORT

ACR BOTS SERVICE PLATFORM	\$4,800 / YR
<ul style="list-style-type: none"> Secure & Customized Customer Portal Deployment Support Tools Fleet & Account Management Tools Knowledge Base & Reference Real-Time Diagnostics & Support Software Updates & Upgrades 	
ACR BOTS CONNECT	\$2,400 / BOT / YR
<ul style="list-style-type: none"> Cellular Connectivity Proactive Diagnostic & Fault Reporting Live Field Data & Productivity Reports Rolling six (6) months data with ability to export 	
GEN4 TIE MODULE	\$10,500
<ul style="list-style-type: none"> Warrantied for the first 150,000 ties and each 150,000 ties upon scheduled service Supports both Plastic Coated & Black Wire 	
SCHEDULED TIE MODULE SERVICE	\$1,500
<ul style="list-style-type: none"> Service at 150,000 ties for continued Tie Module warranty coverage Ground & Overnight shipping available 	
15LB SPOOL 16.5 AWG PLASTIC-COATED WIRE	\$100 / SPOOL
<ul style="list-style-type: none"> Min. order of 108 spools (27 boxes of 4) Includes shipping 	
15LB SPOOL 16 AWG BLACK WIRE	\$75 / SPOOL
<ul style="list-style-type: none"> Min. order of 108 spools (27 boxes of 4) Includes shipping 	
ROBOT SUPERVISOR	\$750 / SHIFT
<ul style="list-style-type: none"> Includes fully tooled truck, spare parts, & per diem \$500 standby rate for non-worked shifts Does not include mileage / transportation cost 	
FIELD SERVICE TECH	\$100 / HOUR
<ul style="list-style-type: none"> Onsite repair not covered under warranty Hourly charged portal to portal Does not include mileage / transportation cost 	